

Ståltau og tilbehør

Steel wire rope and accessories

Socket, lukket type - GN SO1

Closed spelter socket - GN SO1

Støpt, lukket socket i galvanisert eller malt stål.

Kan leveres med 3.1B sertifikat på forespørsel.

Måltoleranse +/- 5%.

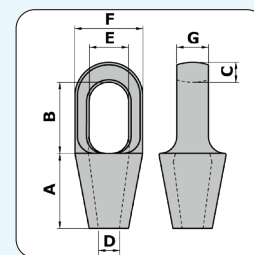

Artikkelnummer	Modell	For wire-diameter mm	WLL ved SF 5:1 tonn	Finish	A mm	B mm	C mm	D mm	E mm	F mm	G mm	Vekt kg
0125350	292	8 - 10	2,4	Galvanisert	58	53	14	11	24	43	16	0,4
0125352	294	11 - 13	4,0	Galvanisert	64	59	18	14	29	51	22	0,7
0125354	296	14 - 16	6,0	Galvanisert	77	65	21	18	35	67	25	1,4
0125356	298	18 - 19	8,0	Galvanisert	90	75	26	21	42	75	31	2,1
0125358	201	20 - 22	12,0	Galvanisert	101	90	33	24	47	92	38	4,0
0125360	204	23 - 26	15,0	Galvanisert	114	103	36	28	57	106	45	5,9
0125362	207	27 - 30	20,0	Galvanisert	127	116	39	32	63	114	51	7,7
0125364	212	31 - 36	25,0	Galvanisert	139	130	44	38	70	128	58	11,0
0125366	215	37 - 39	30,0	Galvanisert	152	155	51	41	79	137	64	14,0
0125368	217	40 - 42	36,0	Malt	165	171	54	44	82	146	70	18,0
0125370	219	43 - 48	46,0	Malt	190	198	55	51	89	171	77	28,0
0125374	222	49 - 54	56,0	Malt	216	224	62	57	98	194	84	40,0
0125378	224	55 - 60	75,0	Malt	228	247	73	65	110	216	94	52,0
0125380	226	61 - 68	85,0	Malt	248	270	80	73	140	241	102	63,0
0125382	227	69 - 75	100,0	Malt	279	286	79	79	159	273	124	89,0
0125384	228	76 - 80	120,0	Malt	305	298	83	86	171	292	133	111,0
0125386	229	81 - 86	140,0	Malt	330	311	102	92	184	311	146	143,0
0125388	230	87 - 93	150,0	Malt	356	330	102	99	197	330	159	166,0
0125390	231	94 - 102	190,0	Malt	381	356	108	108	216	362	178	217,0
0125392	233	108 - 115	240,0	Malt	460	425	120	125	235	405	190	338,0
0125394	240	122 - 130	280,0	Malt	500	475	140	138	270	515	210	579,0
0125396	250	140 - 155	400,0	Malt	580	550	150	160	300	510	250	654,0
0125398	260	158 - 167	500,0	Malt	675	600	175	175	325	600	300	1 063,0