

Ståltau og tilbehør

Steel wire rope and accessories

Wireskive - Møllerblokk

Wiresheave - Møllerblokk

Wireskive for Møllerblokk.

Ta kontakt for andre størrelser.

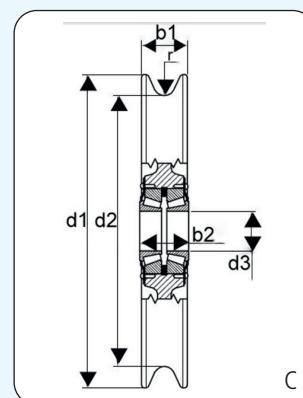
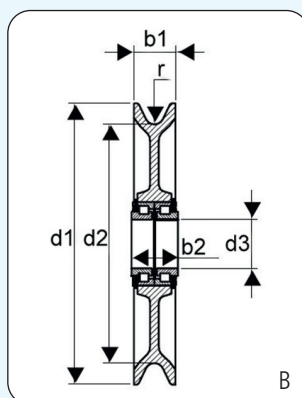
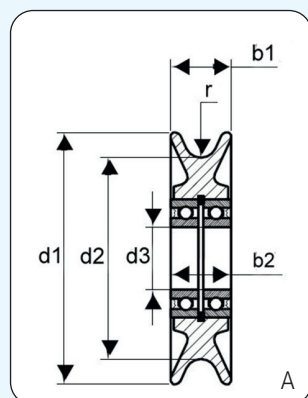

Artikkelnummer	Modell	WLL tonn	Wire-diameter mm	d1 mm	d2 mm	d3 mm	b1 mm	b2 mm	r mm	Vekt kg	Bilde-referanse
0120600	04100-03	2	12	100	80	25	24	26,0	6,3	1,2	A
0120602	04150-03	6	12	100	80	25	24	30,0	6,3	1,2	B
0120604	06100-03	4	10	155	130	40	33	39,0	5,3	2,5	A
0120606	06150-03	20	20	150	100	40	40	38,0	10,5	2,2	B
0120608	09101-03	10	14	230	195	40	34	38,0	7,5	5,0	B
0120610	09150-03	17	22	230	180	55	40	46,0	11,5	5,0	B
0120612	24300-03	10	14	230	190	30	41	46,0	7,5	5,5	C
0120614	24712-03	24	24	230	175	40	64	70,5	12,7	8,5	C
0120616	12101-03	24	18	300	250	40	64	70,5	9,5	10,5	C
0120618	14101-03	24	20	355	290	40	64	70,5	10,5	15,5	C
0120620	16101-03	24	24	400	340	40	64	70,5	12,7	18,0	C
0120622	24600-03	35	26	400	335	50	75	84,5	14,0	24,5	C
0120624	24800-03	35	28	470	400	50	78	84,5	15,0	36,0	C
0120626	20100-03	35	32	515	445	65	75	80,0	17,0	41,0	C

BMM-blokk - enskivet, rustfritt stål

Block - BMM, single-sheaved, stainless steel

Rustfrie blokker (AISI 304) med svivel og kulelager i skivene.

Blokkene kan leveres med hunsvott på bestilling.

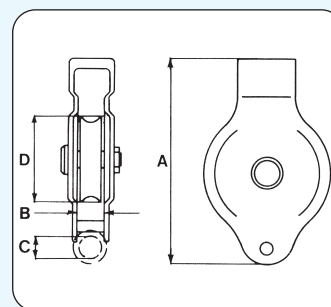
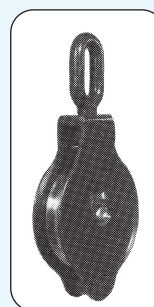

Artikkelnummer	Modell	Maks. belastning på wire tonn	WLL opphengsledd tonn	Maks. wire-diameter mm	A mm	B mm	C* mm	D mm	Vekt kg
0350605	KT 1-1ESSC	1	2	16	163	22	16	80	1,7
0350606	KT 2-1ESSC	2	4	18	195	24	22	110	3,2

*C-målet gjelder kun for spesialbestilte modeller med hunsvott.